



25/19 Blaxland Avenue Newington, NSW



UNDER OFFER in 4 days
Massive 240m2 on title + Huge wrap around balcony.

The Features:

Huge 98m2 terrace, all day sunlight and cross flow ventilation, spacious open plan living and dining, generous eat in kitchen, resort-like gardens and pool.

Level entry with few stairs, + award winning building design.

The Details:

The Deal:

Outgoings: are PQ and approx in nature

Strata - \$2473.93

Council Rates: \$265.50 p/q

Water Rates: \$144.47 p/q

Strata Rates: \$2,473.93 p/q

Stevan Vuk-Luboya

0402 003 003

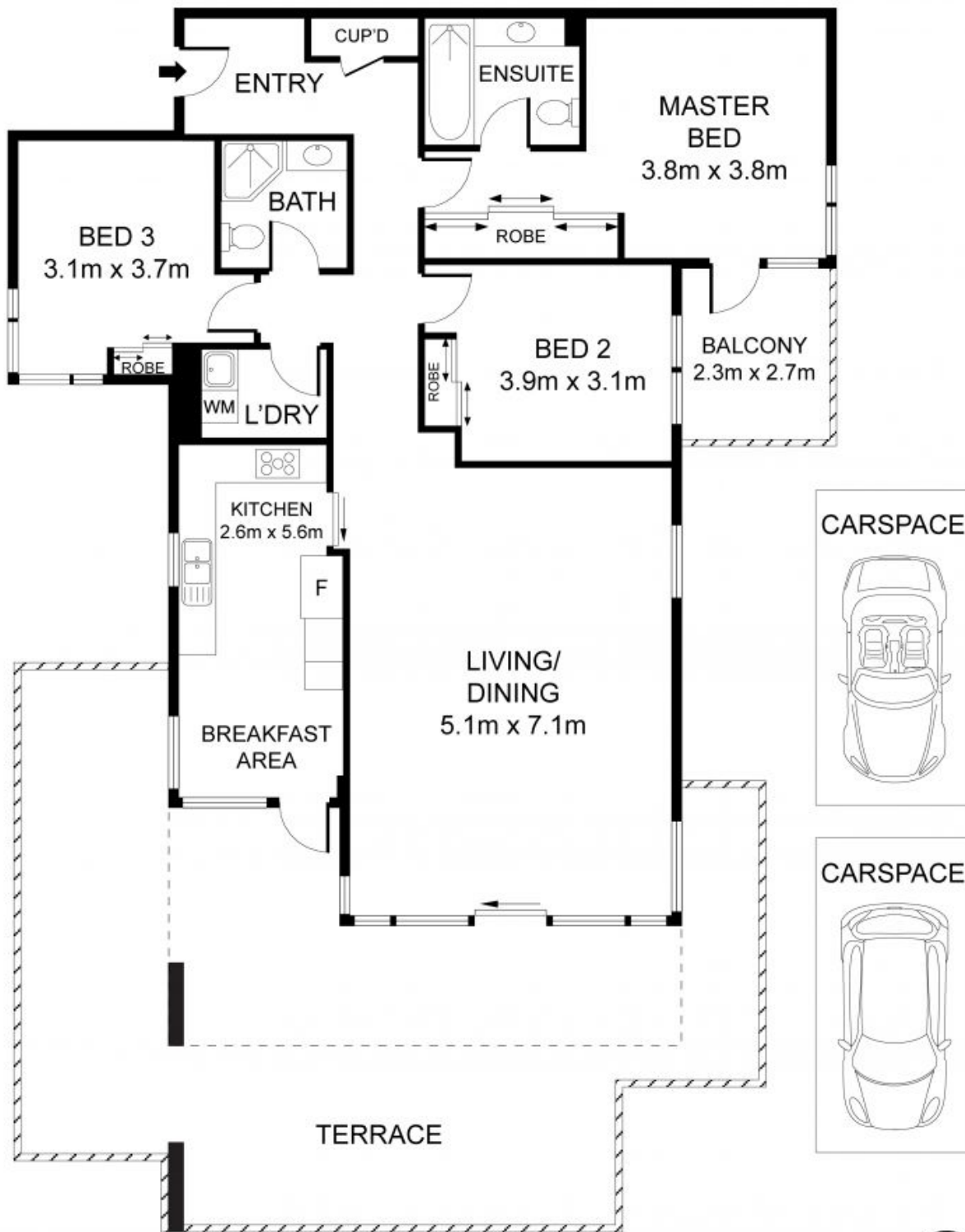

25/19 Blaxland Avenue, Newington

INTERNAL AREA: 124 SQM APPROX.

