



201/549-557 Liverpool Road Strathfield, NSW



Ideally Located, Expertly Designed & Built Inspect By Appointment

The Details:

Perfectly positioned in a convenient location close to shops, schools and public transport, this home offers excellent value. Superbly designed with the latest luxury appliances and quality finishes, beautifully appointed with modern details this apartment ticks all the boxes. An open-plan layout and floor-to-ceiling glass doors provide abundant natural light. Perfect self occupancy or ideal investment opportunity.

Council Rates: \$300.00 p/q

Water Rates: \$220.00 p/q

Strata Rates: \$822.00 p/q

The Features:

- 2 large bedrooms both with built-in robes, main with ensuite.
- Open plan lounge and dining areas with air conditioning.
- Sleek gas kitchen, stone benchtops, premium Blanco appliances.
- Intercom and lift facilities.

Stevan Vuk-Luboya

0402 003 003

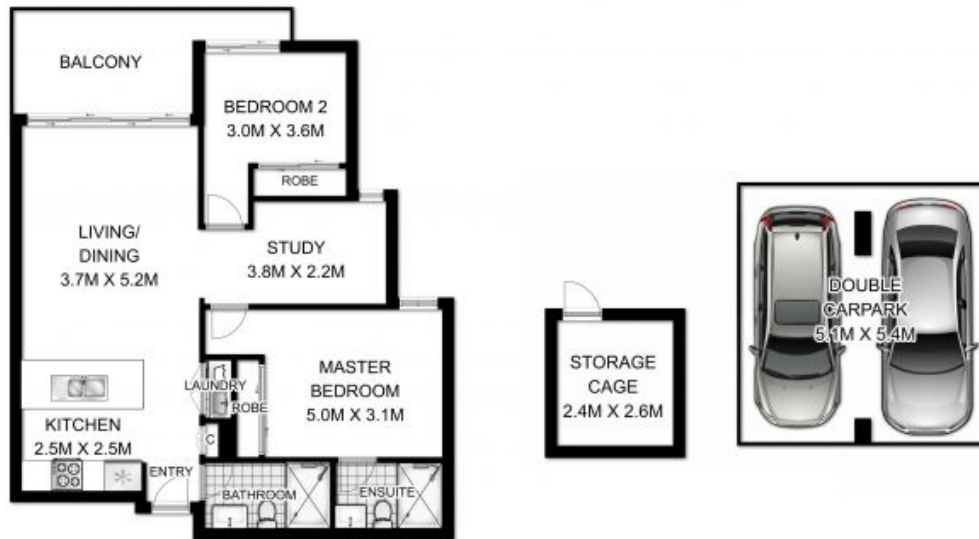

DISCLAIMER: 3D Property View accepts no liability for the accuracy of details contained within our floor plans. All plans are drawn and also checked to the best of our ability, however information contained in our floor plans such as area calculations are approximate, and have not been surveyed or drawn to scale.

201 / 549 Liverpool Road, Strathfield